

Adaptive Buttons in Communicator 5

Setting up the Eye Gaze Actions for the Adaptive Buttons

1. Open Communicator 5
2. Open the **Quick Menu**
3. Select **Advanced Settings**



4. Select **System**
5. Select **Adaptive Buttons**

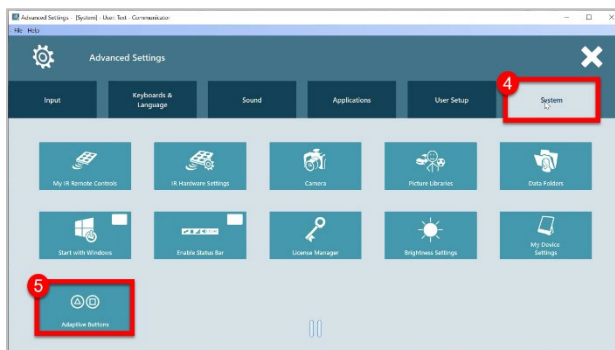

6. Select **Change**

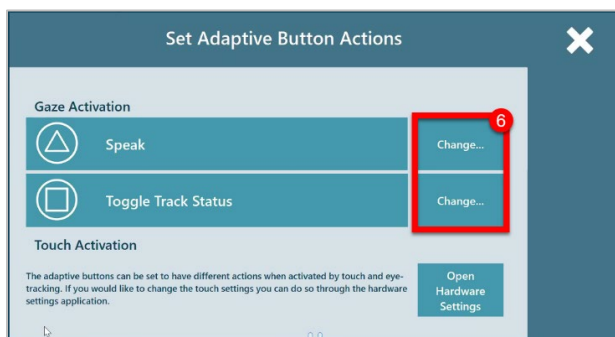

7. Select an **Action**

8. Select **Apply**

Note: the current selected action will be outlined in red, the action outlined in blue will be selected once you hit apply.

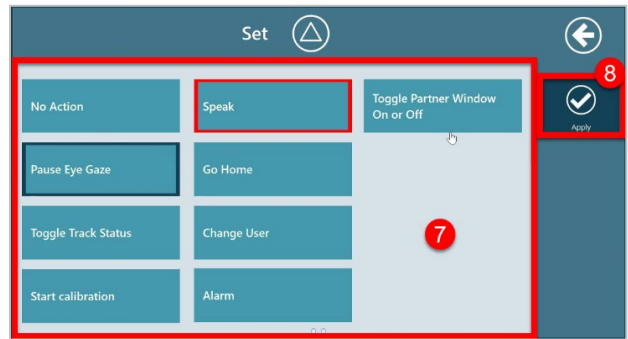

9. **Repeat** the process for the second adaptive button

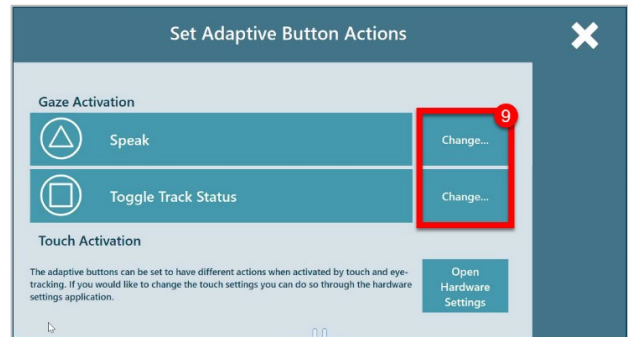

Note: The Settings and Adaptive Buttons Settings page set can also provide access to these setting options, these page sets can be added to any home page.

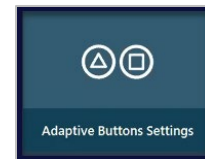
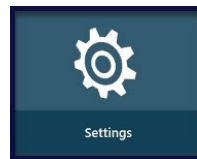

Setting up the Touch Actions for the Adaptive Buttons

From Communicator 5:

1. Follow steps 2 – 5 above
2. Select **Open Hardware Settings**
3. Use the **drop-down menus** to select the touch actions for the adaptive buttons
4. Select the **X** to exit the software
5. Return to **Communicator 5**

